

# FORMING ACCESSORIES

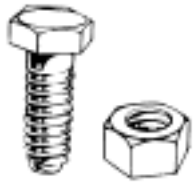

## B11 FITTING UP BOLT AND NUT

Designed to make assembly and disassembly of concrete forms less time consuming. The special tapered point acts as an aid when lining up forms to be bolted together. Manufactured with a special thread design to insure easy threading of nut on bolt. Available in 5/8" x 2" or 3/4" x 2" length.

Steel Spacer Cones								
No.	Rod Size	Large Dia.	Small Dia.	Length	Shebolt Dia.	Hex Size	Rod Disc.	Length Thread on Rod
SS1	5/16"	1-1/4"	3/4"	2-1/4"	1/2" & 9/16"	3/4"	1"	1-1/4"
SS2	3/8"	1-1/8"	7/8"	2-1/4"	9/16"	5/8"	1"	1-1/4"
SS3	3/8"	1-1/8"	7/8"	2-3/4"	9/16"	5/8"	1-1/2"	1-1/4"
SS4	1/2"	1-3/8"	1-1/8"	2-3/4"	7/8"	7/8"	1"	1-3/4"
SS5	1/2"	1-3/8"	1-1/8"	3"	7/8"	7/8"	1-1/2"	1-1/2"
SS6	1/2"	1-1/2"	1-1/4"	3-1/2"	7/8"	7/8"	2"	1-1/2"
SS7	1/2" & 5/8"	1-5/8"	1-1/4"	3"	1"	1"	1-1/2"	1-1/2"
SS8	1/2" & 5/8"	1-5/8"	1-1/4"	3-1/2"	1"	1"	2"	1-1/2"
SS9	1/2"	2-1/8"	1-1/4"	2-1/2"	7/8"	7/8"	1"	1-1/2"
SS10	3/4"	2-3/8"	1-3/4"	4"	1-1/4" & 1-3/8"	1-3/8"	2"	2"

## F4T-SS SPACER CONES

Designed to be used with Shebolt for inside spacing of wall forms.

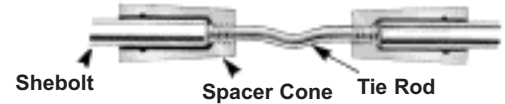

## F4T-SA

## STEEL ALIGNMENT CONES

For aligning and supporting forms prior to and during pouring of concrete. Taper of cone matches taper of shebolt for reattachment.

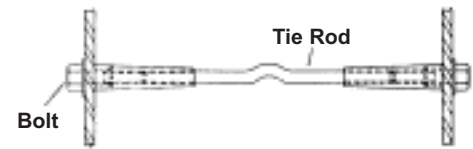

Steel Alignment Cones						
No.	Tapped Thru	Large Dia.	Small Dia.	Length	Shebolt Size	Hex Size
SA1	1/2"	1"	13/16"	3"	1"	1/2"
SA2	1/2"	1"	13/16"	4"	1"	1/2"
SSA3	3/4"	1-1/4"	1-1/16"	4"	1-1/4"	3/4"
SA4	3/4"	1-1/4"	1-5/32"	4"	1-1/4"	3/4"
SA5	3/4"	1-1/4"	1-5/32"	5-1/2"	1-1/4"	3/4"
SA6	7/8"	1-3/8"	1-5/16"	4-1/2"	1-3/8"	7/8"
SA7	1"	1-5/8"	1-1/2"	6"	1-5/8"	1"
SA8	1"	1-5/8"	1-9/16"	6"	1-5/8"	1"

## E-1 EYEBOLTS

Williams eyebolts may be used as lifting eyes for forms, concrete blocks, concrete cylinders, machinery or equipment. The large base on three of the models makes them excellent for anchoring guy wires.

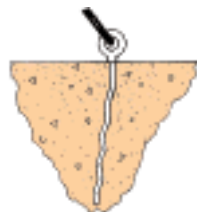

Anchor Guywire



Anchor Bolting



Fig. 1



Fig. 2



Fig. 3

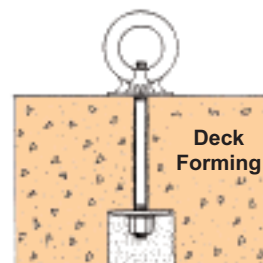

Fig. 4

Part No.	Figure	Approx. Inside Width	Approx. Inside Height	Ring Dia.	Approx. Overall Height	Tap	Straight Tension Ultimate Strengths
NEB 75R Malleable	Fig. 1	4"	5"	1"	7-3/4"	1-2" -3/4"	23,000 lbs. 102.3kN
NEB 50 Malleable	Fig. 2	3"	3"	1"	5-3/4"	1/2"-3/4"	26,000 lbs. 115.6 kN
NEB 1 Malleable	Fig. 3	2"	2"	1-1/8"	5-1/8"	3/4" 7/8"-1"	35,000 lbs. 155.7kN
NEB 100 Steel	Fig. 1	4"	4-1/2"	1-1/4"	8"	1" 1-1/4" -1-3/8"	65,000 lbs. 289.1 kN
NEB 200 Steel	Fig. 4	5"	6"	2"	11"	1-3/8"-2"	150,000 lbs. 667.2 kN



Form Lifting



Deck Forming

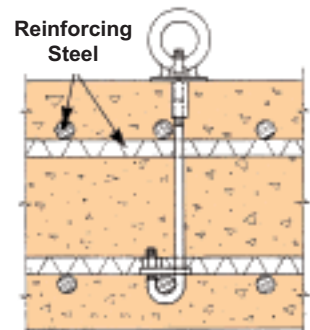

Reinforcing Steel

Safety factors and working loads based on the ultimate strength of the eyebolts should be determined for the specific application by your design agency. A minimum of 4:1 is recommended.