

HEAVY TIE-THRU FORMING

C7T WILLIAMS TAPER TIE SYSTEM

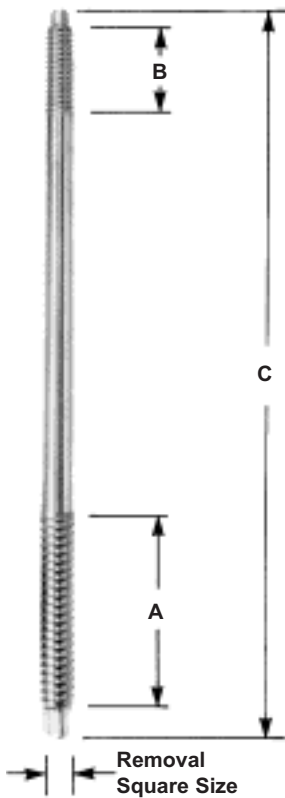

WILLIAMS Taper Tie System consists of totally reusable hardware. The one piece Taper Tie is ideal because of its fast assembly and easy strip feature. The adaptability of the WILLIAMS Taper Tie to varying wall thickness makes it economically ideal. Available with varying degrees of taper. WILLIAMS Taper Ties should be properly lubricated before inserting into the form. Taper Ties should be checked periodically for wear, and cleaned immediately after use. A special dome on the small end protects the threads from hammer blows.

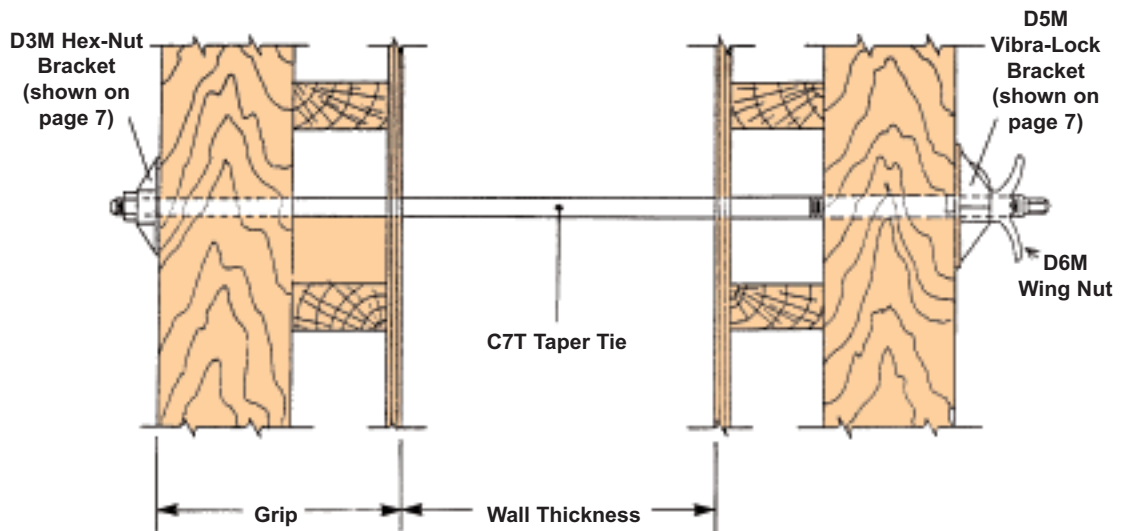

WHEN ORDERING SPECIFY:

- Working Load Requirement
- Diameter
- Length (C)
- Thread Type

TAPER TIE LENGTHS

$$\begin{aligned} &\text{Maximum Wall Thickness} \\ &+ (2 \times \text{Form Grip}) \\ &+ 8 \text{ Inches}^* \\ \hline &= \text{Taper Tie Length} \\ &\text{(select standard from table)} \end{aligned}$$

*(for brackets, removal squares and domed end)

Diameters	Square Size	Working Load Lbs./kN	Ultimate Strength Lbs./kN	D6M WING NUTS	
				A End	B End
3/4" -1/2"	7/16"	7,500/ 33.4	15,000/ 66.7	W3	W1
1"-3/4"	5/8"	18,000/ 80.1	36,000/ 160.1	W5T	W5
1-1/4" -1"	13/16"	34,000/ 151.2	68,000/ 302.5	W6T	W5T
1-1/2" -1-1/4"	13/16"	50,000/ 222.4	100,000/ 444.8	W11	W6T
*1-5/8"-1-3/8"	1"	58,000/ 258.0	116,000/ 516.0	W11	Hex Nut

Other lengths available upon request. Specify Acme or Coil thread.
Working loads based on 2 to 1 Safety Factor.

*These non-stock diameters are available in acme thread only (must special order).

*Length C	Thread Length	
	Large (A)	Small (B)
30"	6"	4"
36"	8"	6"
42"	8"	8"
48"	8"	8"
54"	8"	8"
60"	10"	8"

* ± 1/2" tolerance

HEAVY TIE-THRU FORMING

TAPER TIES ADJUST TO VARYING WALL THICKNESS

All hardware for this system is totally re-usable. The same taper tie may be used to form multiple wall thickness as well as battered walls.

Williams "Time-Saving Advantages:"

- Steeper taper angle - offers quicker stripping
- Higher working loads - offer faster pour rates.

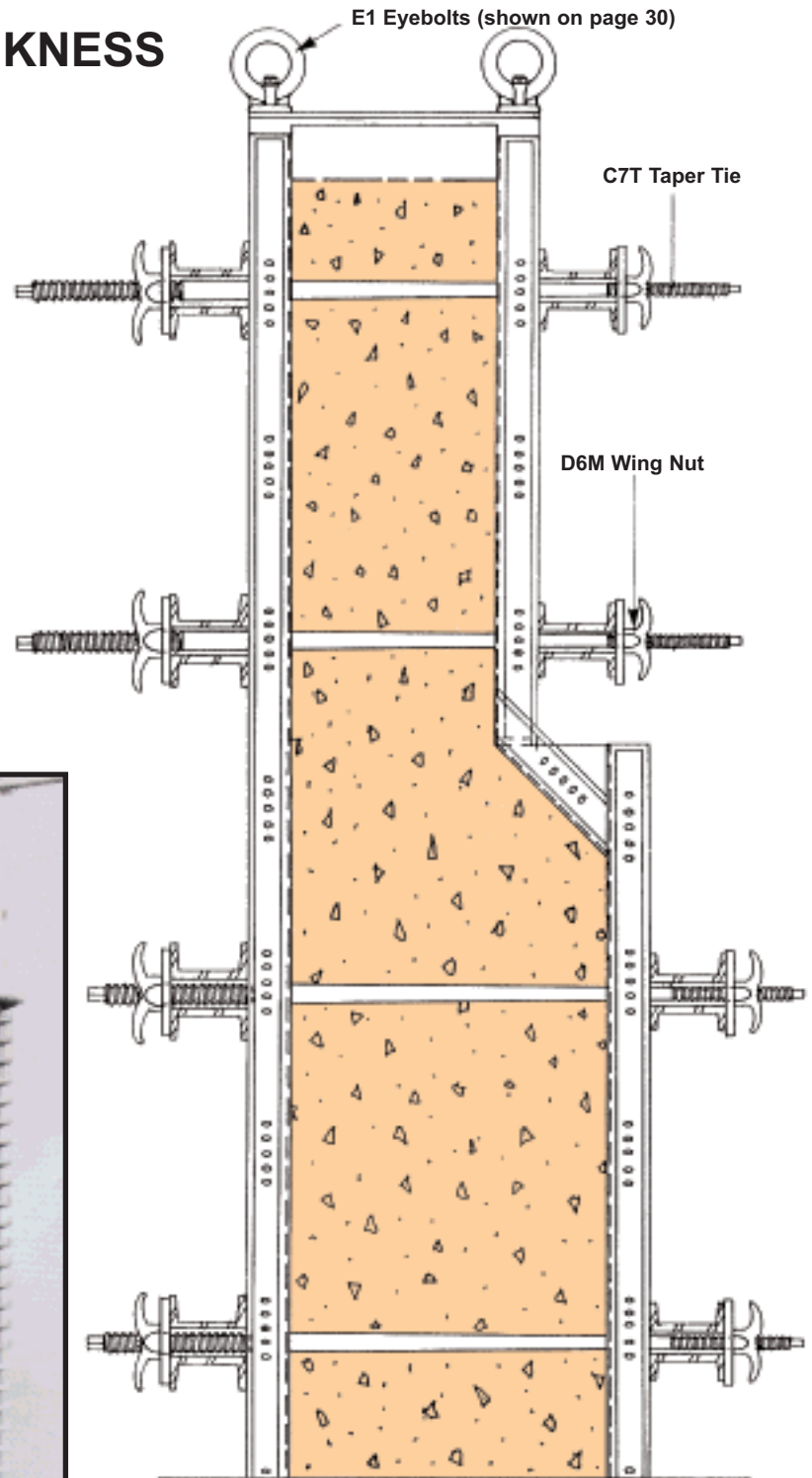

Plaza Ventia Condominiums - Miami, FL
Sub-Contractor: Arrow Forming